

DESENHO TECNICO

Desenho de moveis e detalhes

- ➡ PLANTA BAIXA DO MÓVEL
- ➡ COTAS
- ➡ ELEVACÃO
  - ▶ SENTIDO DE ABERTURA DE PORTAS
  - ▶ INDICAÇÃO DE GAVETAS E PRATELEIRAS
  - ▶ INDICAÇÃO DE PEÇAS ESPECIAIS
- ➡ ESPECIFICAÇÃO
  - ▶ O QUE É
  - ▶ MATERIAL
  - ▶ FERRAGEM
  - ▶ MEDIDA
  - ▶ ACABAMENTO
- ➡ PUXADORES
- ➡ DETALHES CONSTRUTIVOS IMPORTANTES

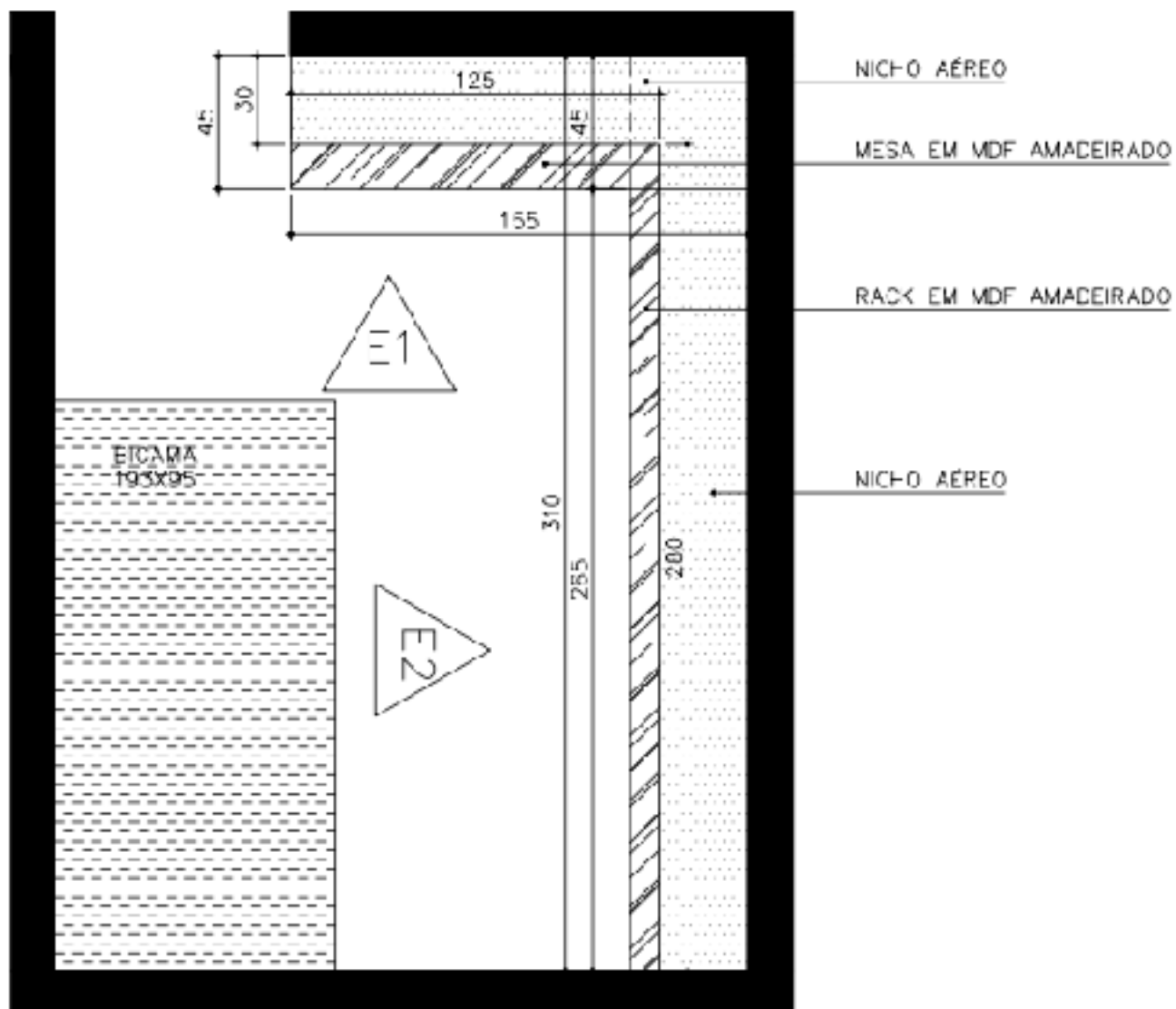

**PLANTA BAIXA MARCENARIA**  
**ESCALA 1/25**

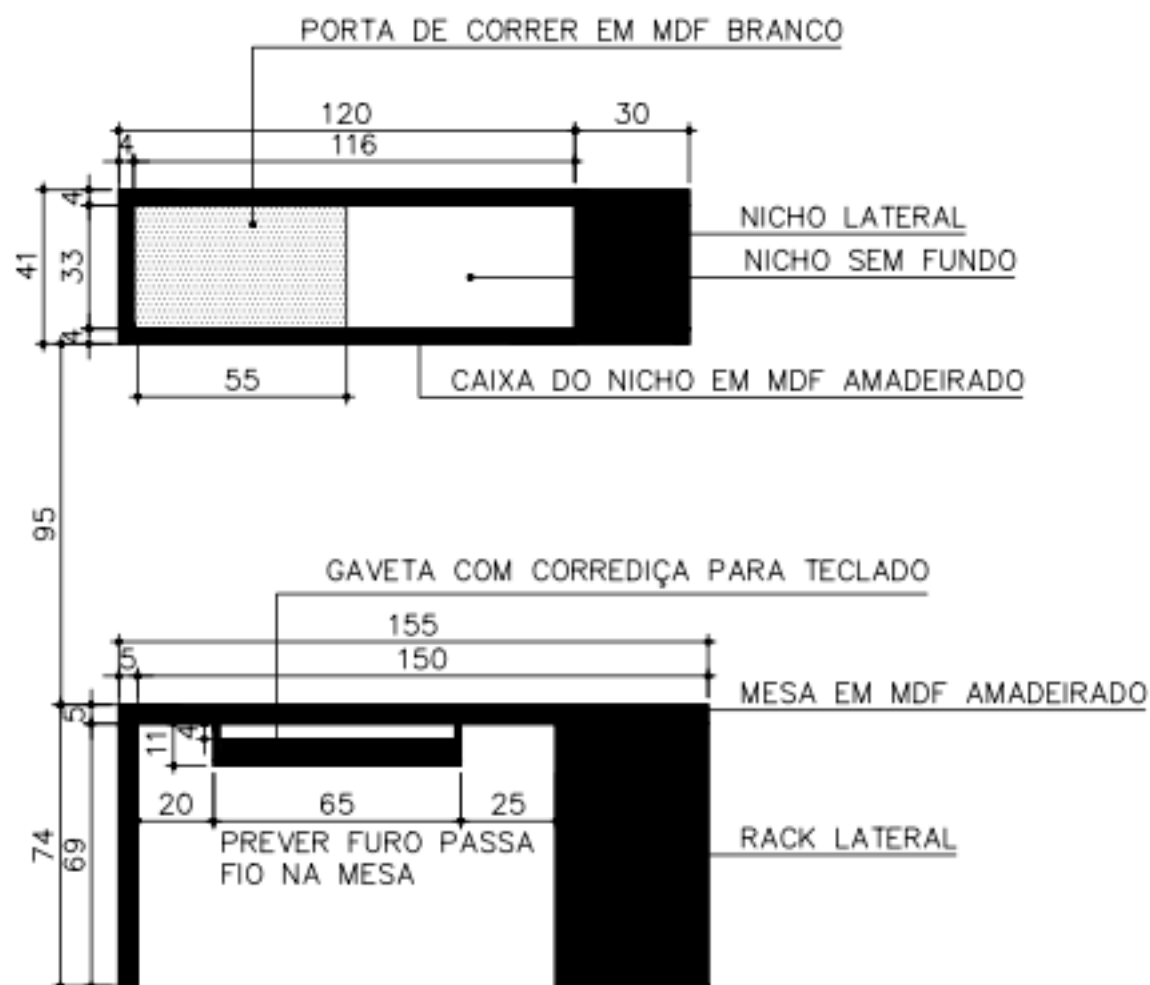

**ELEVAÇÃO 01**  
**ESCALA**

**1/25**

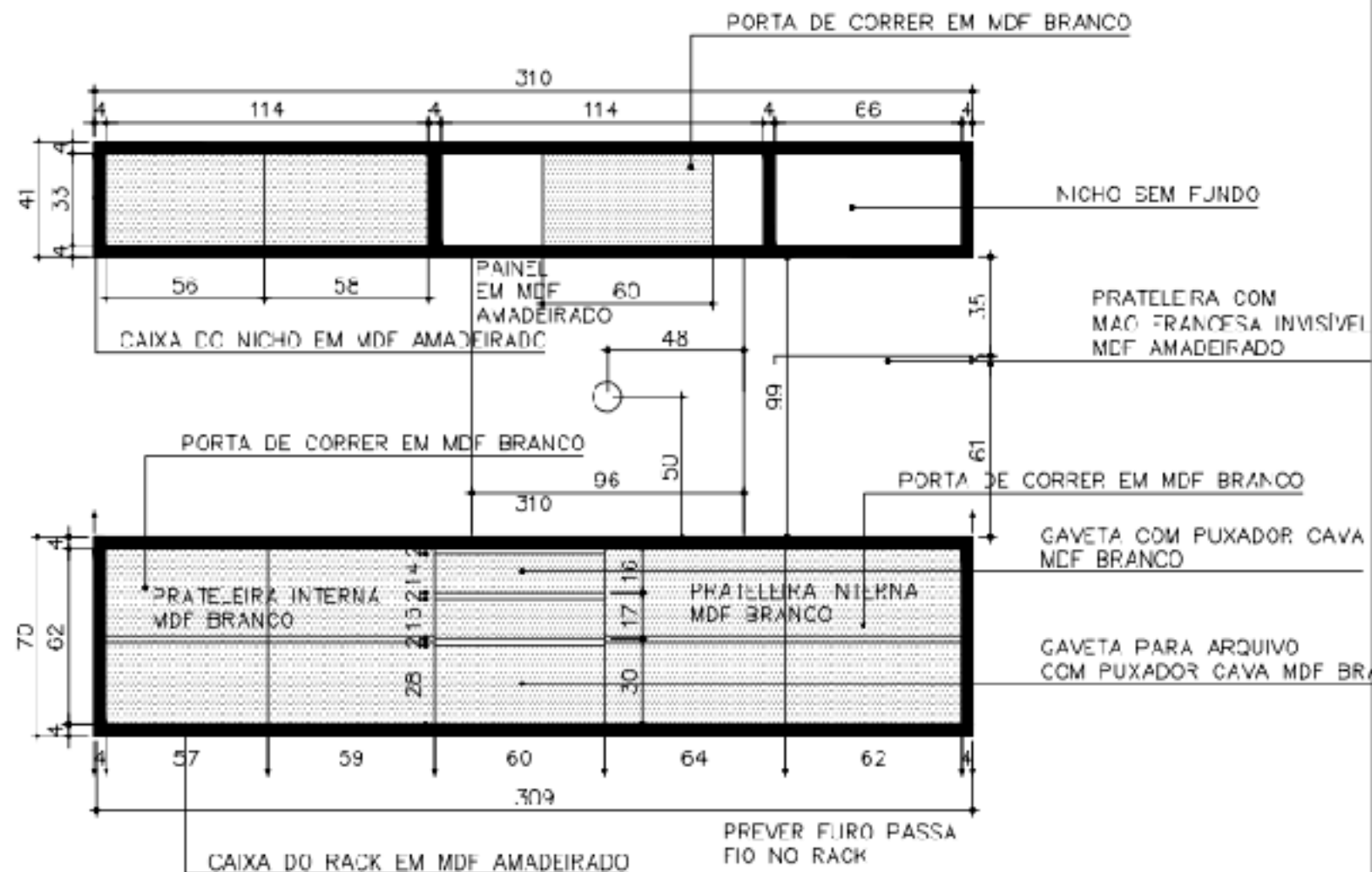

**ELEVAÇÃO 02**

**ESCALA**

**1/25**

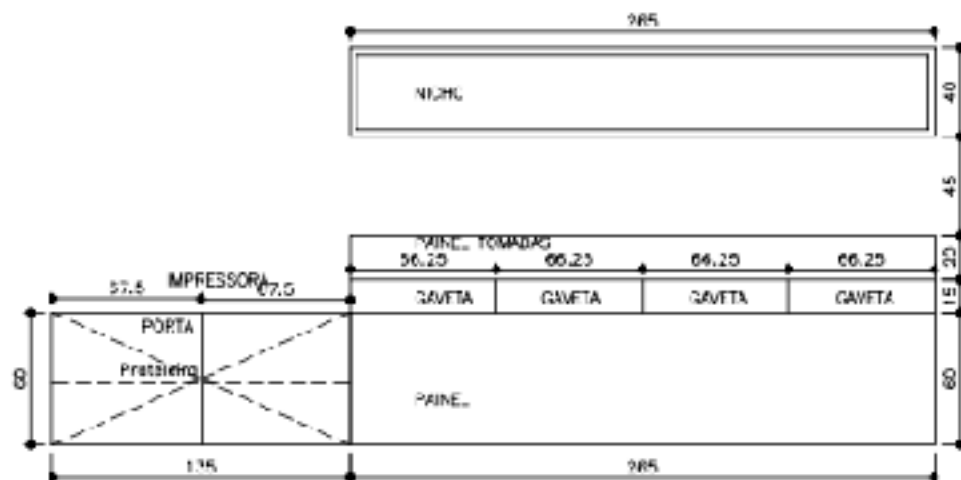

ELEVAÇÃO ESCRITÓRIO

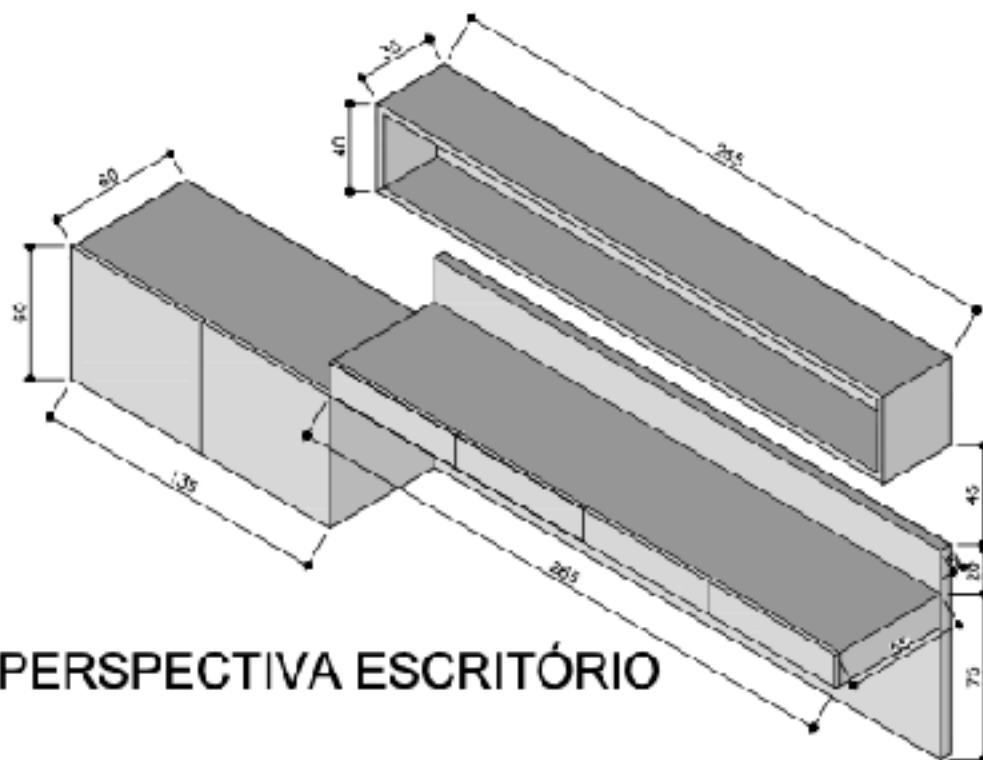

PERSPECTIVA ESCRITÓRIO

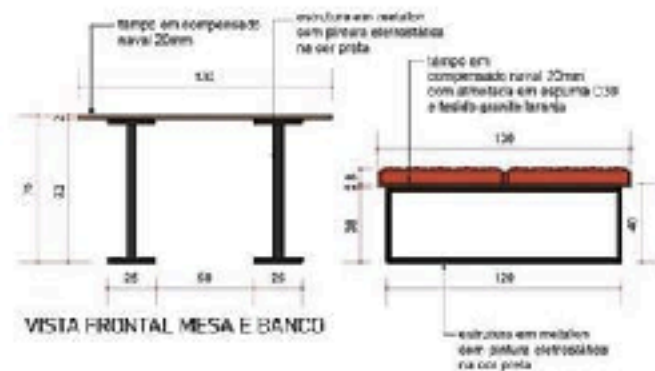
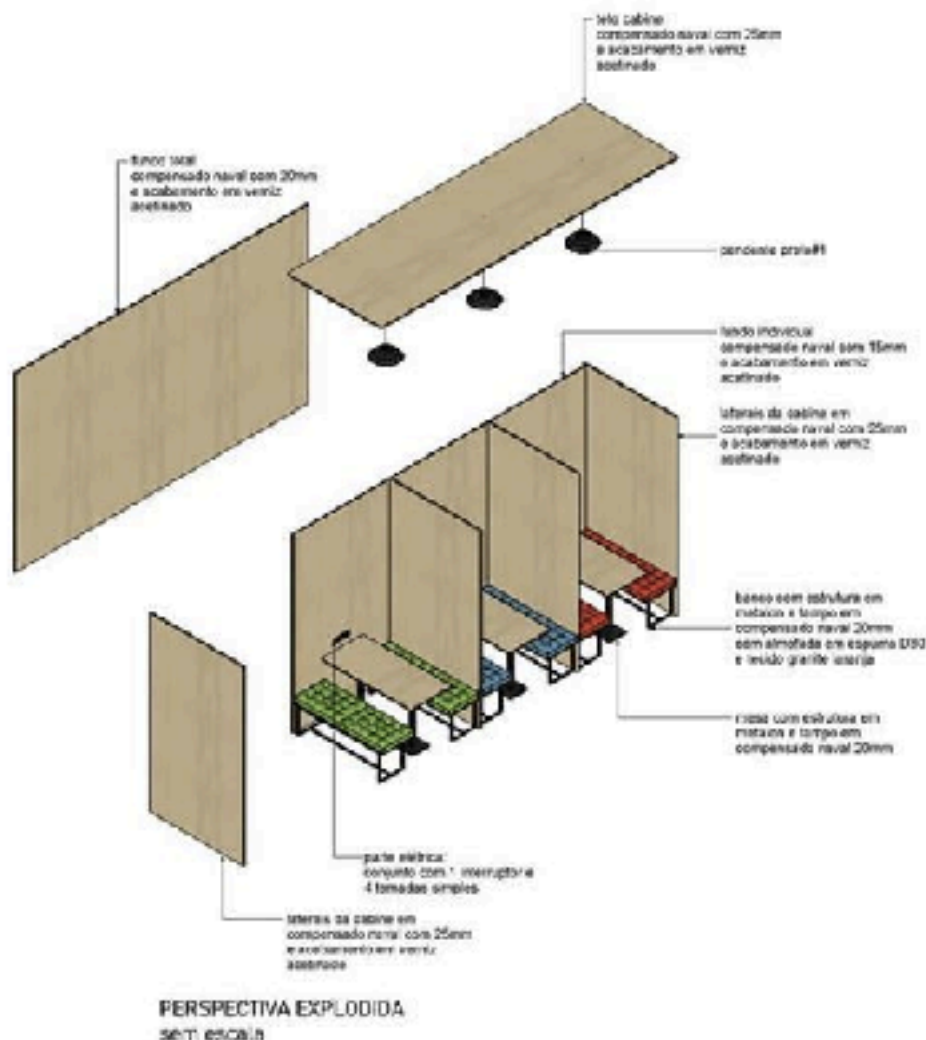



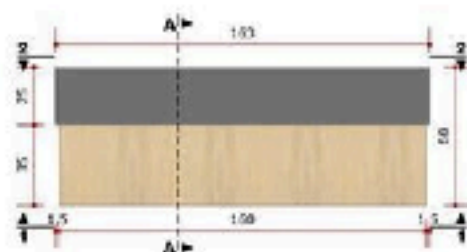

VISTA 1

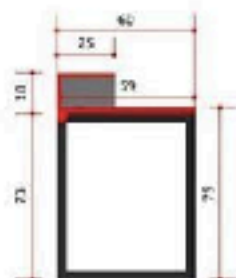

CORTE A



VISTA 2

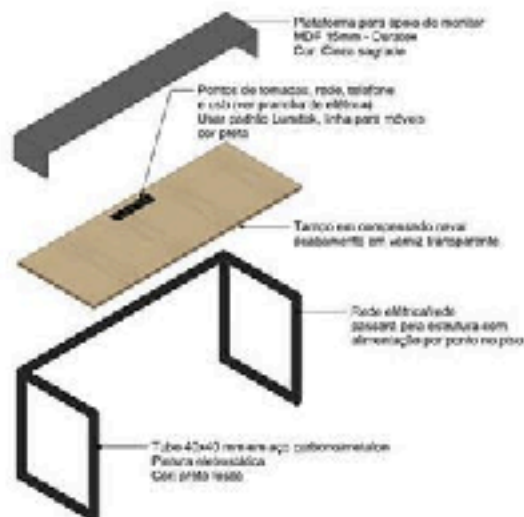

1 Det. Mesa ADM  
A303 1:25

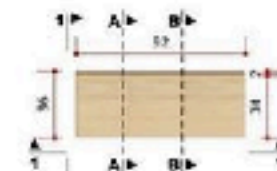

VISTA 1



VISTA 2

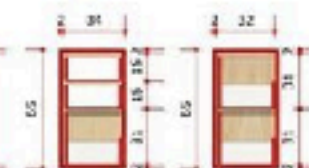

CORTE A

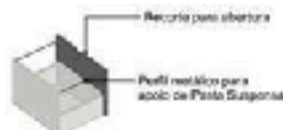

2 Det. Gavetão  
A303 1:25



CORREDIÇA SIMPLES



CORREDIÇA OCULTA



CORREDIÇA TELESCÓPICA

**Para porta sobreposta:**

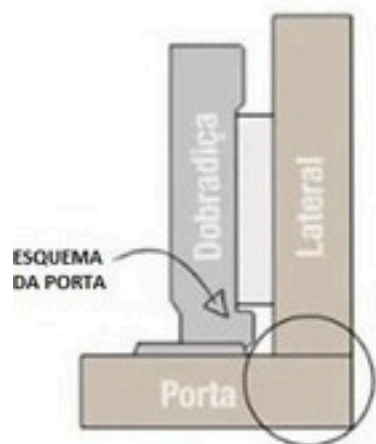

**dobradiça reta**



**Para porta parcialmente sobreposta:**

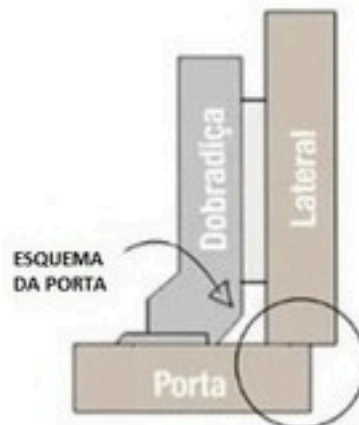

**dobradiça curva**



**Para porta embutida:**



**dobradiça super curva**



**SISTEMAS DE DOBRADIÇAS**

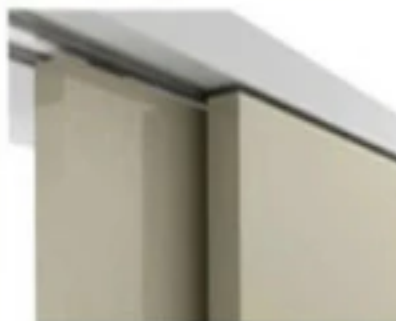
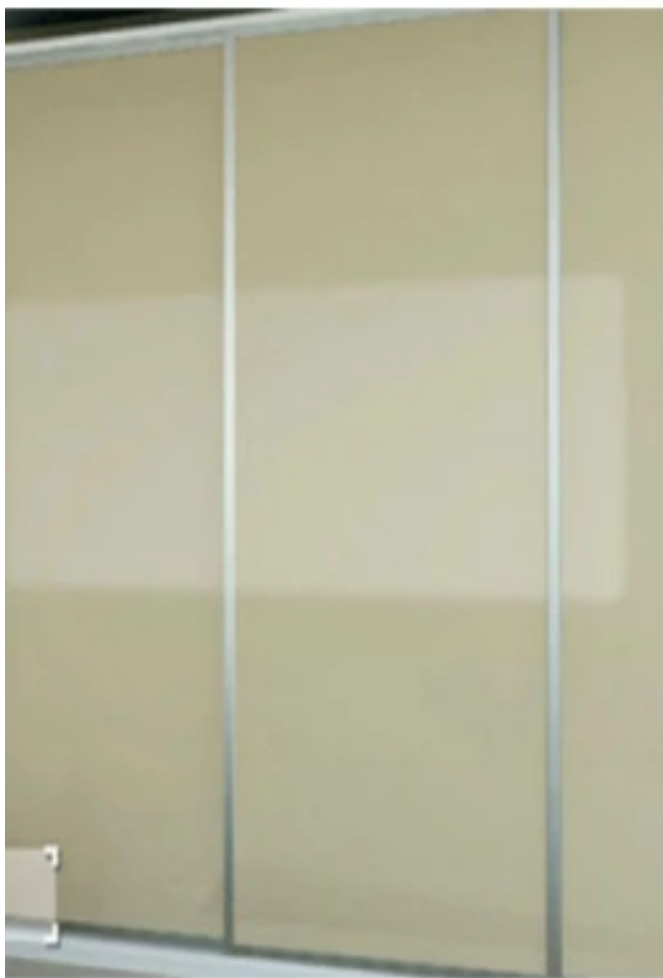

TRILHO DE GUIA





TRILHO DE GUIA



TRILHO DE CARRO





TRILHO DE CARRO



BÁSCULA COM PISTÃO